

PROFILE VIEW

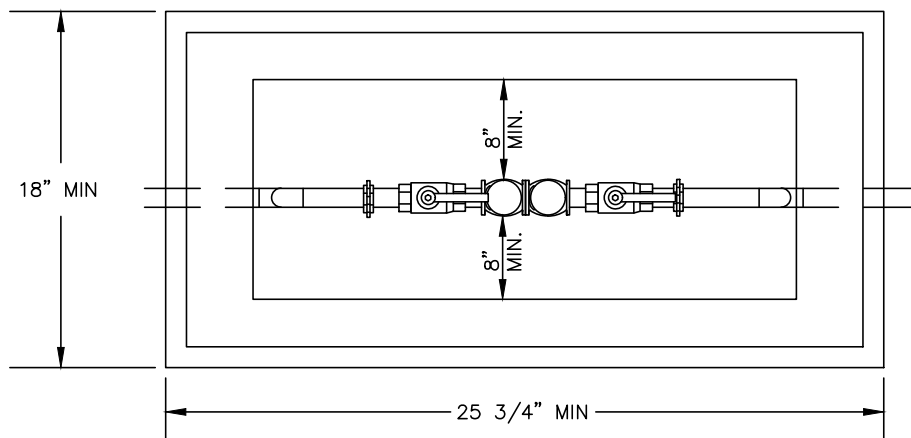

PLAN VIEW

NOTES

1. MUST BE ON THE LATEST DEPT. OF HEALTH APPROVED LIST OF BACKFLOW PREVENTION ASSEMBLIES.
2. MUST BE INSTALLED BELOW GROUND IN AN APPROVED VAULT.
3. FREEZE PROTECTION IS THE RESPONSIBILITY OF THE OWNER.
4. RISERS AND ALL PIPE IN BOX TO BE BRASS, COPPER, OR PVC.
5. THE DCVA SHALL NOT BE INSTALLED WHERE IT MAY BECOME SUBMERGED.
6. A TOWN CROSS CONNECTION SPECIALIST SHALL INSPECT INSTALLATION OF DEVICE AND RECEIVE TEST REPORTS PRIOR TO ESTABLISHMENT OF WATER SERVICE OR APPROVAL. TEST REPORTS MUST BE SIGNED BY A CERTIFIED BACKFLOW ASSEMBLY TESTER AND IMMEDIATELY SENT TO THE TOWN.
7. FOR 2 1/2" TO 3 1/2" DCVA'S, USE A UTILITY VAULT 506-LA WITH LOCKING STEEL DOOR NO. 55-332.P.
8. FOR 4" AND LARGER DCVA'S, USE A UTILITY VAULT 687-LA WITH BASE 684SB AND 2 LOCKING STEEL DOORS NO. 686-TL-2-332P.
9. FOR 1" AND SMALLER DCVA'S USE CARSON INDUSTRIES "1220-12" OR EQUAL (21 1/2"x15") FOR 1 1/4" TO 2" DCVA USE CARSON INDUSTRIES " JUMBO BOX 1730-12" OR EQUAL (33 1/2"x20 1/2")

NO SCALE

	<p>APPROVAL</p> <p><i>Wayne R. Hauske</i></p> <p>PUBLIC WORKS DIRECTOR</p>
	<p>DATE</p> <p>01/21/2022</p>
<p>DOUBLE CHECK VALVE ASSEMBLY (DCVA) INSTALLATION</p>	
<p>REV:</p>	